

# Outlaw<sup>1072s</sup>

## PORTABLE POWER STATION

### Offer your customers more possibilities with a portable lithium solution

With the Outlaw 1072S your customers can now power their essentials while off-the-grid or keep the lights on when things go dark. From laptops and lights to TVs and refrigerators, the Outlaw 1072S is strong enough to power what they need, when they need it, and lightweight enough to take with them anywhere.



### FEATURES OF THE OUTLAW 1072S:

- ✔ **Multiple Ways to Use:** It features 2 AC, 3 USB-A, 2 USB-C, 2 barrel jacks at 12V, 12V car port plug, and an EC5 30amp DC port
- ✔ **Easy to Recharge:** AC wall charger included and 12-25V/160W max solar input charging
- ✔ **High Capacity:** 921.6Wh (72Ah) LiFePO4 battery capacity with 1000W continuous and 2000W peak
- ✔ **Safe & Reliable:** Lithium iron phosphate chemistry that's inherently safe. The battery management system (BMS) and UL1642 certified internal cells provide multiple layers of protection.
- ✔ **LCD Screen:** Displays capacity, watts in/out and remaining run time.
- ✔ **Long Life:** Long-lasting daily use at 3500+ cycles

### APPLICATIONS:



CAMPING



OVERLAND



HIKING



HUNTING



BACK UP  
POWER



ALTERNATIVE  
HOME POWER  
SOURCE

Power Without Li<sup>3</sup>mits



## PRODUCT SPECIFICATIONS

### OUTLAW 1072S RUNTIME

**50W Laptop**

15.6 Hours

**50W LED String Light**

15.6 Hours

**50W Mini Refrigerator**

15.6 Hours

**75W Portable Speaker**

10.4 Hours

**100W LED TV**

7.8 Hours

**150W Electric Blanket**

5.2 Hours

**1000W Electric Grill**

1 Hour

**350W Personal Heater**

2.2 Hours

*\*Recharging and run times will vary depending on usage, power consumption rating of actual used devices and the number of devices connected to the Outlaw at one time.*

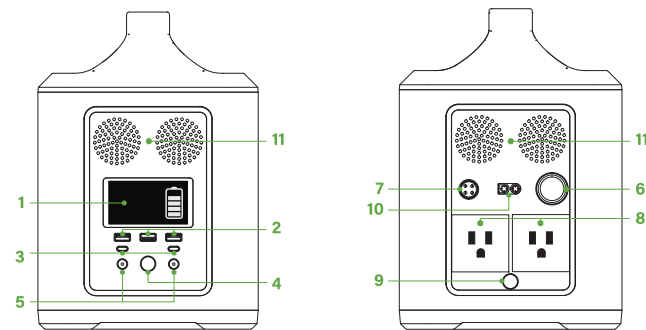

- 1. Built-in LCD screen displays runtime and watts in/out
- 2. Type-A outputs
- 3. Type-C outputs
- 4. DC power button
- 5. DC output ports
- 6. 12V car port
- 7. Input DC in charger port
- 8. AC outputs (Region specific: NAM, EUR, ANZ)
- 9. AC power button
- 10. Quick port (30A in/out)
- 11. DC fan cooling vents

### PRODUCT SPECIFICATIONS

Capacity	12.8V 72Ah
Weight	31.63 lbs (14.35 kg)
Dimensions	14.48 x 7.87 x 10.82 in. (368x200x275 mm)
Battery	LiFePO4
Lifecycles	3500
BMS	Under Voltage Protection
	Over Voltage Protection
	Over Current Protection
	Short Circuit Protection
Warranty	1 Year

### OUTPUT PORTS

DC/PV Input	DC 14.6V/Max10A Support PV 15-25V/160 Watt Max
Car Port	12V@10A
DC Port	2x (12V/10A)
DC Quick Port	1x 30A Quick In/Out
Type-C PD	2x @ 36W max
Type-A Output	1x @ 12W max
	Quick Charge 3.0
AC Output	2 @ 24W max
	2x110V-9.09A, 60Hz, 1000W, 2000W Peak (Pure Sine Wave Inverter)